

How do I update my Chrome device?

How do I check if my Chrome device is up to date?

Step 1: Restart the Chromebook (hold down the power button for 3 seconds, let go of the power button for 3 seconds, then press and release the power button).

Step 2: Log in to the Chromebook using your username@powayusd.com account and district password.

1. Click the status area in the lower-right corner.
2. Click the **Settings icon**

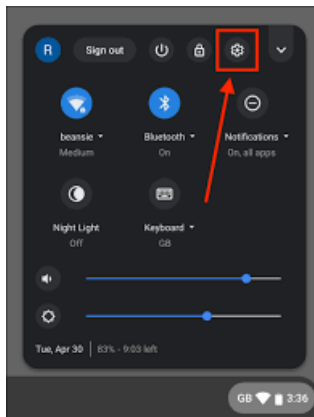

3. On the left side, near the bottom of the page, click **About Chrome OS**
4. In the "About" window, click the "**Check for and apply updates**" button.

To find out what Chrome OS version a Chromebook is on, press ALT + V while on the logon screen.